

## 700 Series Assemble Stand

### **Purpose**

The document is aimed to illustrate the procedure of stand assembly for 700 series scanners.

### **Scope**

This document is applicable to SG7XX, SG7XXBT, LG7XX, LG7XXBT, IG7XX and IG7XXBT series scanners.

### **Components**

Each component of the stand is illustrated as following.

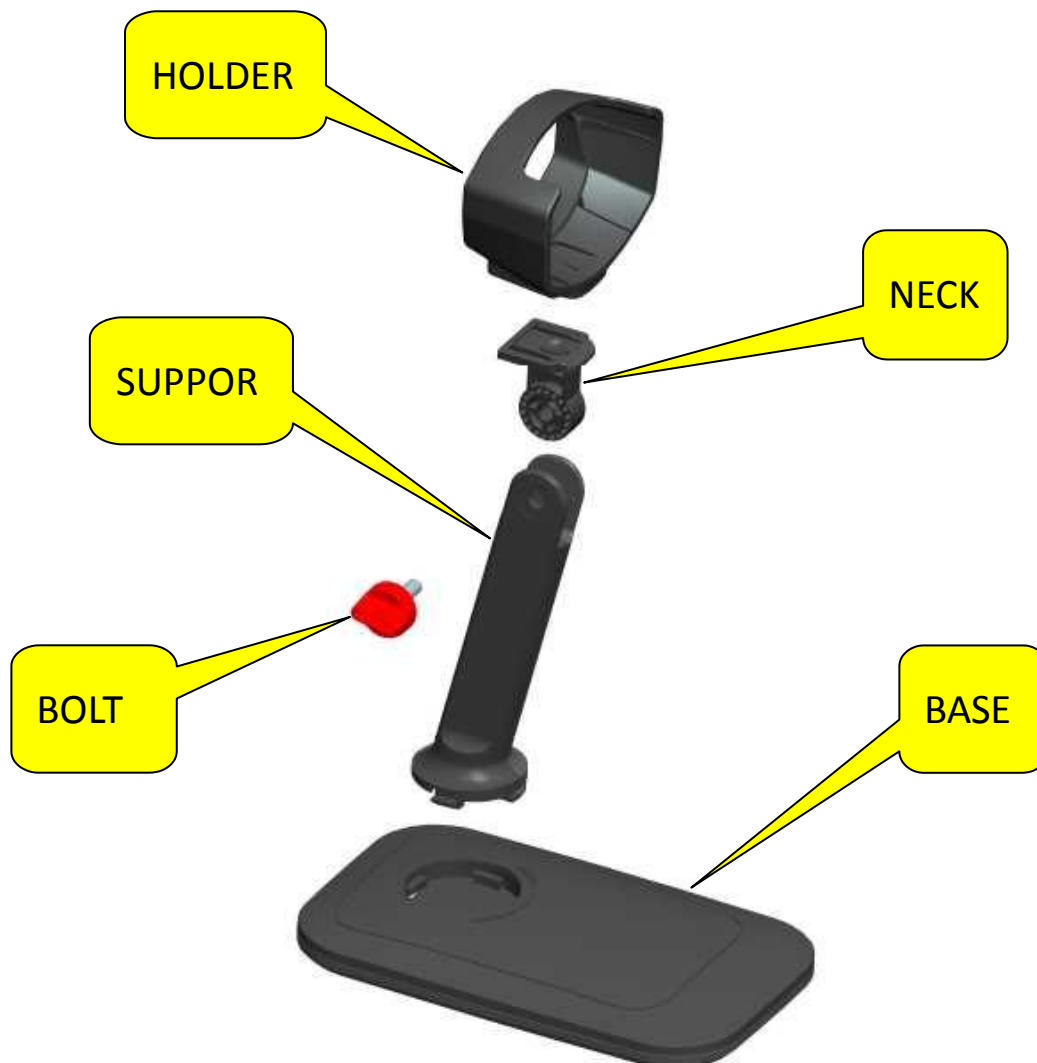

## Procedure

Please follow the procedure below to assemble stand.

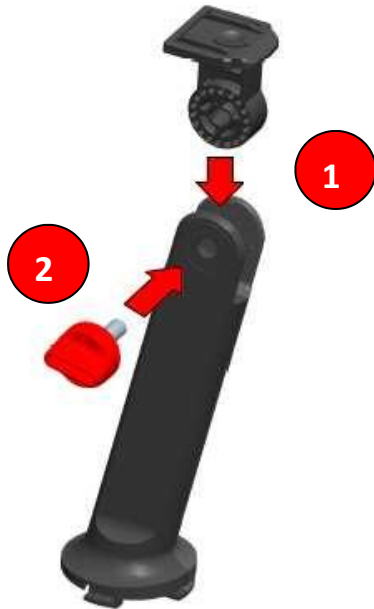

**1** Insert the NECK on the top of SUPPORT.

**2** Insert and secure the BOLT in the screw hole.

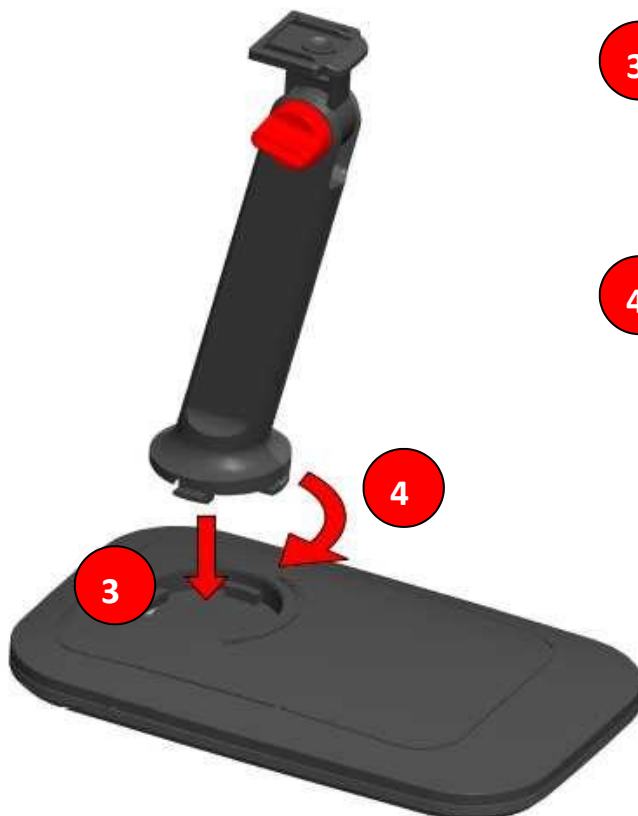

**3** Insert the SUPPORT on the BASE.

**4** Turn the SUPPORT clockwise about 45° until locked on the BASE.



**5** Attach the HOLDER on the NECK.



Finish assembly.